

BLINDSPARTS.COM

LEVOLOR CORD TILT
INSTALLATION

Blindparts.com
5732 E. 7th Street
Tucson AZ 85711
Phone (520) 745-1275
Fax (520) 745-1277

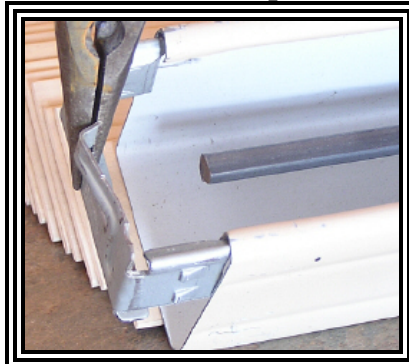

Remove the head rail spacer end cap.



You can now slide the tilt rod out of your broken tilt gear and remove it.



If you have a wand control tilt gear punched head rail, & are converting to a cord tilt gear, you need this cord guide.

Insert the Cord through the plastic Cord Guide

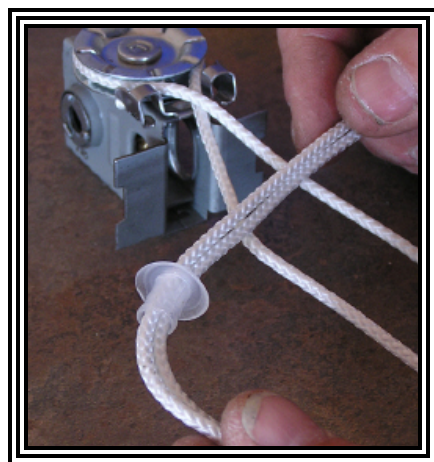
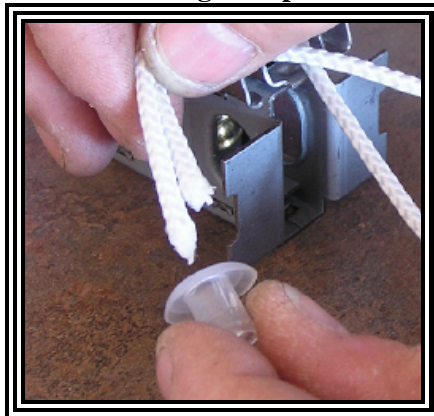

Insert Cord through the hole in the head rail

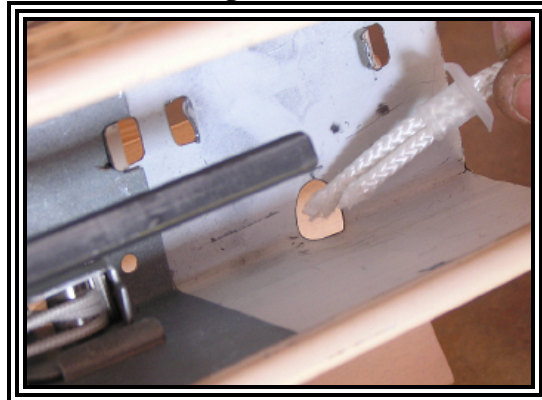

Pull the cord to bring the gear into the head rail

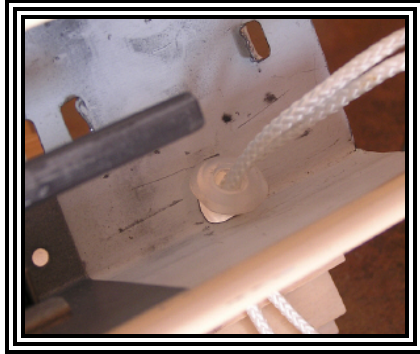

Guide your tilt gear into place

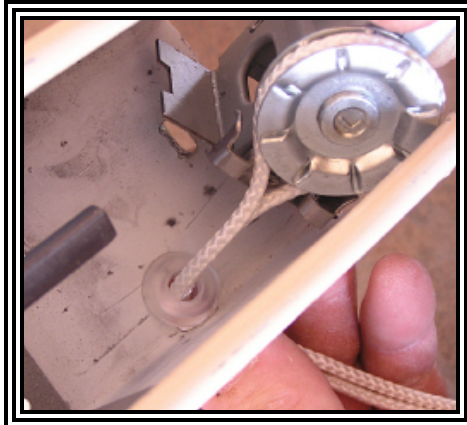

Bend down the metal tabs to filter

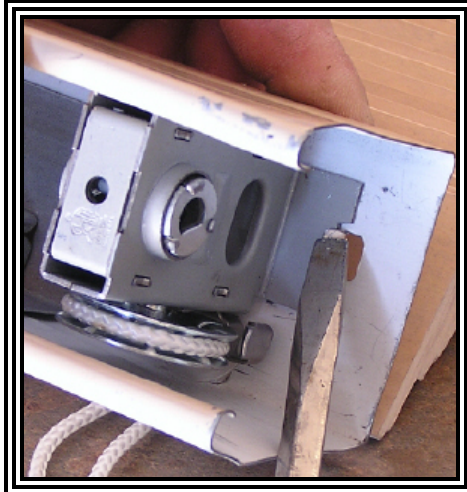

**Line up the tilt rod to the gear shape
Make sure your ladder barrels face up & louvers are in the open position**

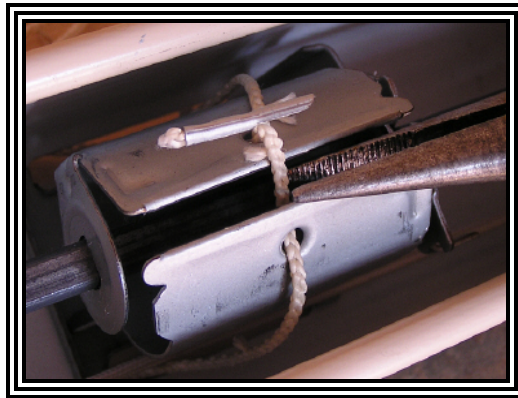
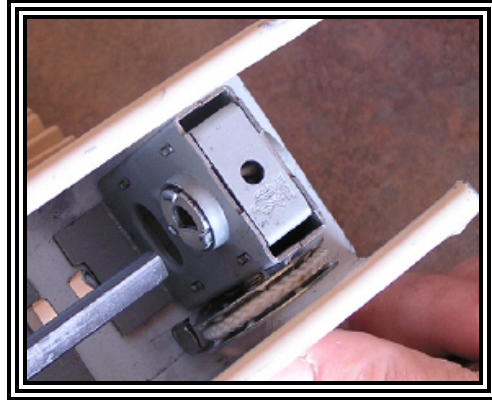

**These tilt gears also have a blank spot to prevent over turning of the slats
The tilt gear will hit this spot, & will stop turning during operation, if not centered**

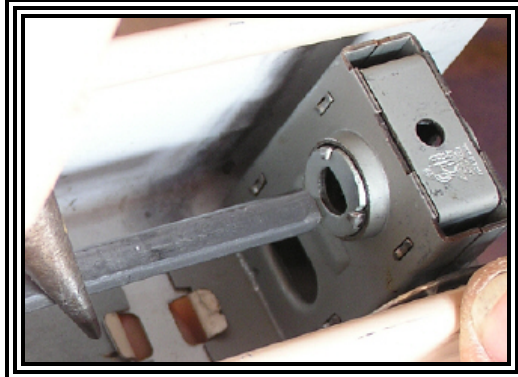

After everything is centered, push the tilt rod through

